

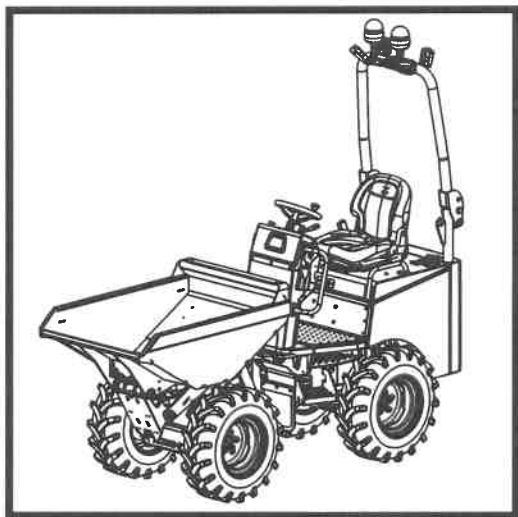

BELLE DX 1000HT

870/90002/5
10/23



(GB) Operators Manual

4

2

UKCA Declaration of Conformity

3

EC/EU Declaration of Conformity



BELLE
LIGHT
CONSTRUCTION
EQUIPMENT



*****5439784

Declaration Of Conformity (DOC)

We, **Altrad Belle, Sheen, Nr. Buxton, Derbyshire, SK17 0EU, GB** declare that the DoC is issued under our sole responsibility and belongs to the followings product(s):



PRODUCT TYPE

MODEL.....

SERIAL No.....

DATE OF MANUFACTURE

SOUND POWER LEVEL
MEASURED /
.....(GUARANTEED)

WEIGHT

Object of the Declaration:

Diesel engine powered dumper for handling various types of on-site waste and rubble from various landscaping and construction applications.

The object of the declaration described above is in conformity with the relevant **Statutory Requirements**:

- **2008 No. 1597** Supply of Machinery (Safety) Regulations 2008
- **2001 No. 1701** Noise Emission in the Environment by Equipment for use Outdoors Regulations 2001
- **2016 No. 1091** Electromagnetic Compatibility Regulations 2016
- **2012 No. 3032** The Restriction of the Use of Certain Hazardous Substances in Electrical and Electronic Equipment Regulations 2012

The following designated standards and technical specifications have been applied:

- **EN ISO 12100:2010** Safety of machinery
- **BS EN 474-6:2006+A1:2009** Earth-moving machinery. Safety. Requirements for dumpers
- **BS EN ISO 3471:2008** Earth-moving machinery. Roll-over protective structures.
- **ISO 3744:2010** Acoustics — Determination of sound power levels and sound energy levels of noise sources using sound pressure

ANP CERTIFICATION LTD. (Approved Body, number 8500) 2 Parkfield Street, Manchester, M14 4PN, UK carried out Internal Control of Production with Assessment of Technical Documentation and Periodical Checking as per Schedule 9 of SI 2001 1701

Technical Files are held by **Ray Neilson** at the Altrad Belle address stated above:-

Place of Declaration:-

Sheen,
Nr. Buxton,
Derbyshire,
SK17 0EU,
UK

Signed by:

Ray Neilson

Date of Declaration:-

October 2023

Managing Director
On behalf of Altrad Belle
Sheen, Derbyshire, UK

GENERAL SAFETY

For your own personal protection and for the safety of those around you, please read and ensure you fully understand the following safety information. It is the responsibility of the operator to ensure that he/she fully understands how to operate this equipment safely. If you are unsure about the safe and correct use of the dumper, consult your supervisor or Altrad Belle.



WARNING

Improper maintenance can be hazardous. Read and Understand this section before you perform any maintenance, service or repairs.

This machine is designed to eliminate the possible risks arising from the use of it. However, risks **DO** reside, and these residual risks are not clearly recognizable, and may cause personal injury or property damage, and possible death. If such unpredictable and unrecognizable risks become apparent, the machine must be stopped immediately, and operator or his supervisor must take appropriate measure to eliminate such risks. It is sometimes necessary that the manufacturer must be informed of such event for future counter measuring.

ALWAYS keep the Operator's Manual and any other manuals that accompany this machine to hand. Immediately replace any manuals that may have been lost or are now illegible.

The Operator's Manual should be stored in the following location underneath the lockable seat pan (*See Image*)

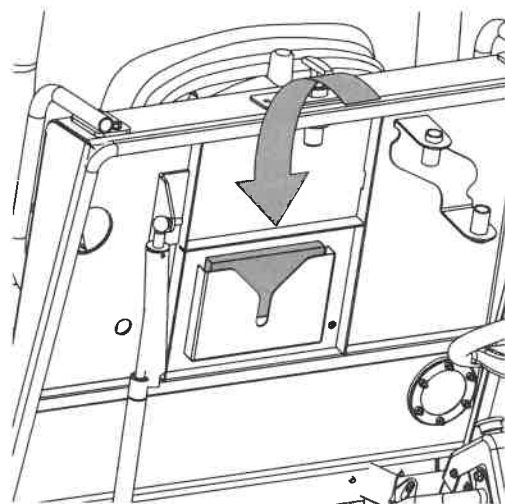

PRE-START CHECKS

The following Pre-start-up inspection must be performed before the start of each work session or after every four hours of use, whichever is first. Please refer to the service section for detailed guidance. If any fault is discovered, the dumper must not be used until the fault is rectified.

1. Check that all instruments and warning lights on the dashboard are functioning correctly.
2. Ensure all lights and indicators function correctly (if fitted)
3. Thoroughly inspect the dumper for signs of damage. Check components are present and secure.
4. Check fluid lines, hoses, filler openings, drain plugs and any other areas for signs of leakage. Fix any leaks before operating.
5. Check the engine oil level and top up as necessary.
6. Check the engine fuel level and top up as necessary.
7. Check for fuel and oil leaks.
8. Check that all tyres are inflated correctly. Check for penetration by any sharp objects / damage.
9. Check wheel nut torques - tighten if necessary (see page 74)
9. Ensure any access panels are closed closed correctly and locked if possible.

Once all the above checks have been made, drive the dumper short distance to check the steering, transmission and brakes are functioning correctly.

OPERATING THE MACHINE

- **ENSURE** the operator has had adequate training prior to use, is familiar with all controls and knows how to safely switch the dumper **OFF** before it is switched **ON** in case you get into difficulty. In some areas and worksites, you may be required to be trained and assessed in accordance with an operator competence scheme
- Suitable PPE **MUST** be worn when using this equipment i.e. Safety Goggles, Gloves, Ear Defenders, Dust Mask and Steel Toe capped footwear (with anti-slip soles for added protection). Wear clothing suitable for the work you are doing and **DO NOT** wear loose jewellery that could be caught in moving parts
- **ALWAYS** inform colleagues of what you will be doing and where you will be working.
- **DO NOT** operate the machine when you are ill, feeling tired, or when under the influence of alcohol.
- During use the engine becomes very hot, allow the engine to cool before touching it. **NEVER** leave the engine running and unattended.
- **ALWAYS** fully lower the dumper skip before moving the dumper.
- **NEVER** get on or off during travel or operation! Never jump off the machine!
- **NEVER** allow anyone except the operator to ride on the machine.
- **NEVER** use the dumper as a platform to work on.
- **NEVER** remove or tamper with any guards fitted, they are there for your protection. Always check guards for condition and security, if any are damaged or missing, **DO NOT USE THE DUMPER** until the guard has been replaced or repaired.
- **DO NOT** stand the machine on end with the engine running.
- **ALWAYS** adapt your travel speed to suit the working conditions.
- **ALWAYS** keep your hands and feet within the confines of the machine whilst the dumper is moving.
- **NEVER** operate the machine whilst incorrectly seated on the dumper. This could result in serious injury or death.
- If the dumper begins to roll over, **NEVER** leave the machine as this could result in serious injury or death. You **MUST ALWAYS** stay seated on the dumper with your seatbelt fastened.
- This dumper has a SWL (Safe Working Load). **ENSURE** you read the Technical Data section of this manual before using the dumper as overloading the dumper can damage the machine, make it unstable risking serious injury or death



WARNING

The dumper has limits. Operating the dumper beyond these limits is extremely dangerous and can lead to damage to the machine as well as serious injury or even death.

- **NEVER** drive through puddles, they may be covering hidden hazard that could compromise the stability of the dumper.
- **DO NOT** drive over debris or obstacles as this may cause the dumper to roll over.
- **ALWAYS** accelerate smoothly and slowly when driving a loaded dumper forward. If you accelerate fast or with jerky movements, the load may fall or the machine may become unstable.
- **ENSURE** that your route is clear of obstacles and be aware of any personnel present in the vicinity of the where the dumper is being operated.
- **ALWAYS** reverse at slow speeds.
- If you turn the dumper too quickly or too sharply, the machine could become unstable. Turn slowly and smoothly at all times.

WORKSITES

- Ensure the operator is familiar with the working surroundings. Worksites can be hazardous.
- Cordon off the work area and keep members of the public and unauthorized personnel at a safe distance.
- **NEVER** operate the dumper too close to the edges of pits, precipices, etc. The weight of the dumper may cause the edge to give way.
- Banks and trenches may collapse. **DO NOT** operate the dumper close to banks or trenches where there is a danger of the material collapsing.
- A high or heaped dumper skip can reduce the operator's view. **ALWAYS** travel with the dumper skip lowered.
- **DO NOT** operate the dumper in confined spaces without adequate ventilation. Exhaust fumes can kill!!
- **ENSURE** all local regulations which affect the dumper are adhered to.
- Take care when moving the dumper with the ROPS in the folded position. **DO NOT** fasten the seat belt to allow easy an exit of the dumper in an emergency. Only move the dumper on stable, level ground. During movement, **DO NOT** operate the dumper body. **ALWAYS** return ROPS to working position immediately once low obstacle is overcome.
- **NEVER** operate the dumper controls without the ROPS securely fastened in the work position.
- Plan and manage work near electric overhead power lines so that risks from accidental contact or close proximity to the lines are adequately controlled.



WARNING

You could be electrocuted, badly burned or even killed if the dumper becomes too close to overhead power lines.



Safety Instructions

PUBLIC ROADS

- **ALWAYS** observe the applicable rules and regulations for the area in which you are travelling. It is the operator's responsibility to ensure these are followed.
- It is illegal to use a steering wheel knob when travelling on the public road. The use of this may cause serious injury or death.
- **NEVER** travel on a public road with the skip loaded or raised.
- It is illegal to use the green flashing beacon on public roads. This must be switched **OFF**.
- When crossing bridges and tunnels, or when passing under overhead lines, make sure there is sufficient clearance height and width.

GRADIENTS

- Never operate the machine on a gradient steeper than 25% (1/4) or 16% (1/6) for a sideways gradient.
- An unladen dumper **MUST ONLY** be reversed up a gradient or driven forwards down a gradient.
- A laden dumper **MUST ONLY** be driven forwards up a gradient or reversed down a gradient.
- **NEVER** exceed 5mph when operating on a gradient.
- If possible, avoid parking the dumper on a gradient.

BATTERY

- **NEVER** isolate the battery when the engine is running. This may cause serious damage to the dumper electrics.
- Before carrying out any welding on the dumper, the battery must be disconnected.
- **NEVER** use a battery if the electrolyte is frozen. **ALWAYS** keep the battery at full charge to prevent the electrolyte from freezing.
- Before disconnecting and connecting the battery **ENSURE** switches are set to off. When disconnecting the battery, take off the earth (-) lead first. When reconnecting, attach the positive (+) lead first.
- Batteries contain caustic sulphuric acid which will cause severe burning. Avoid contact with eyes, skin or clothing. Always wear safety glasses and acid resistant gloves when handling the battery.

EXTERNAL CONTACT

- Flush the affected area with generous amounts of water. Seek medical attention immediately.

EYES

- Flush with generous amounts of clean water for at least 15 minutes. Seek medical attention immediately.

INTERNAL CONTACT

- Drink large quantities of water or milk. Follow with milk of magnesia, beaten egg or vegetable oil. Call a doctor immediately.
DO NOT take fluids that will induce vomiting.

- A frozen battery can explode if an attempt is made to charge or jump start the machine. Allow the battery to thaw before attempting either operation.
- To prevent the battery from freezing, always maintain the battery at full charge.
- Hydrogen gas contained within the battery is explosive. **DO NOT** make contact with naked flames, sparks, burning cigarettes etc. when charging the battery or while the engine is running.
- **DO NOT** short circuit the battery terminals with metal items.
- **ALWAYS** check the electrolyte level with the engine switched **OFF**. **NEVER** add electrolyte to a charged battery, use only distilled water.
- Replace battery if cracked or leaking.

TRANSPORTATION

- This dumper is heavy. Use suitable lifting equipment to lift the machine using the designated lifting point.
- Always switch **OFF** the engine before transporting, moving it around the site or servicing it.
- **DO NOT** use the dumper to transport people.
- If transporting the dumper on a trailer bed, **ALWAYS** use the designated strapping hooks and **ENSURE** the parking brake is applied on the machine.

TOWING

- The dumper has a Tow Hitch option but the dumper is not a tractor and must **NEVER** be used as such on difficult terrain.
- If the dumper is used on site for towing trailers, the payload must be distributed with 25% in the dumper skip and 75% in the trailer. The maximum payload for the dumper must **NEVER** be exceeded with the combination of towed equipment and the weight in the dumper skip.
- **ENSURE** the Tow Hitch is secured to the dumper as per the Assembly Instructions.
- The handling and steering capabilities of the dumper can be affected when towing.
- **ALWAYS** refer to the owners manual of the equipment being towed when coupling to the dumper. **ONLY** couple them with the specially designed equipment.
- If using optional equipment such as a trailer, **ENSURE** that all lights and related indicator lamps are mounted and working correctly.

FUEL SAFETY



WARNING

Diesel is flammable. It may cause injury and property damage. Shut down the engine, extinguish all open flames and do not smoke while filling the fuel tank. Always wipe up any spilled fuel.

- Before refuelling, switch off the engine and allow it to cool.
- When refuelling, **DO NOT** smoke or allow naked flames in the area.
- Spilt fuel must be made safe immediately, by using sand. If fuel is spilt on your clothes, change them.
- Store diesel in an approved, purpose made container away from heat and ignition sources.
- If fuel is spilt when re-fuelling the tank, wipe off the excess and wait 2 minutes before re-starting.

OIL AND LUBRICANTS

- When handling oil, grease and other chemical substances observe the product-related safety regulations (safety data sheet)
- If any oil or lubricants are swallowed **DO NOT** make the person vomit and seek medical attention as soon as possible.
- If the oil or lubricants comes into contact with skin or in the eyes, flush with lots of water for at least 15 minutes. Seek medical advice.
- Use a suitable container to collect fluids and lubricants as they flow out and dispose of them in an environmentally friendly manner
- **ALWAYS** store oil and lubricants in secure labelled containers.

DURING MAINTENANCE

- Carry out maintenance and repair work only if the dumper is positioned on stable and level ground and has been secured against inadvertent movement and buckling.
- **NEVER** service the machine while the engine is running, always switch OFF.
- **ALWAYS** chock wheels before starting any maintenance work.
- **NEVER** place yourself or any part of your body under a raised section of the machine that is not supported correctly. If the machine moves unexpectedly, you may be trapped, seriously injured or killed.
- Clean the dumper, especially connections and threaded unions, of any traces of oil, fuel or preservatives before carrying out maintenance/repair. Never use aggressive detergents. Use lint-free cleaning rags.
When dismantling assemblies containing components under pressure from springs, always wear suitable PPE. This will protect against eye injuries from accidental flying components.
- Hydraulic fluid at system pressure can injure you. Depressurise all system sections and pressure pipes to be removed in accordance with the instructions for the part concerned before carrying out any repair work.
- When handling oil, grease and other chemical substances, observe the product related safety regulations.
- Before cleaning the dumper with water, steam jet (high-pressure cleaning) or detergents, cover or tape up all openings which - for safety and functional reasons - must be protected against water, steam or detergent penetration. Special care must be taken with electrical equipment.
- **Work on the electrical system or equipment must only be carried out by a skilled electrician. The electrical equipment of the dumper is to be inspected and checked at regular intervals. Defects such as loose connections or scorched cables must be rectified immediately.**

AFTER MAINTENANCE

- **ALWAYS** tighten any screwed connections that have been loosened during maintenance and repair.
- Any safety devices removed for set-up, maintenance or repair purposes must be refitted and checked immediately upon completion of the maintenance and repair work.
- **ENSURE** that all consumables and replaced parts are disposed of safely and with minimum environmental impact.

MODIFICATIONS & REPLACEMENT PARTS

- **NEVER** make any modifications or additions to the machine without the prior approval of Altrad Belle. Any unapproved modifications may affect the performance and safety of the machine. This may also void the Warranty.
- **ALWAYS** use genuine Altrad Belle replacement parts. Use of non-genuine replacement parts may affect the performance and safety of the machine. This may also void the Warranty.

Genuine Altrad Belle replacement parts can be purchased online at www.Altrad-Belle247.com



Safety Instructions

WEATHER CONDITIONS

- Lightning can kill! **DO NOT** use the dumper if there is lightning in the area.
- Rain can alter the condition of the worksite surface area. **ALWAYS** be aware of the condition of the surface before and during operation of the dumper adapt your travelling speed to the prevailing surface conditions.
- Operating the dumper in poor visibility can result in serious injury or even death. **ALWAYS** use your lights to improve the visibility of the area.
- If the dumper is to be left outside in freezing temperatures for more than a day without being used, remove the battery and store indoors.
- **DO NOT** charge a frozen battery. If you charge a frozen battery, or jump start the engine, the battery may explode.
- **NEVER** use a battery if the electrolyte is frozen. **ALWAYS** keep the battery at full charge to prevent the electrolyte from freezing.

RISK ASSESSMENT

It is the responsibility of the operator to ensure that the dumper is used in a safe manner, taking into account all aspects of the worksite and working conditions on and around the worksite.

The following are given as a guide to be taken into account when the risk assessment is made. There may be others factors that need to taken into consideration also.

OPERATOR

- Is the operator of the dumper sufficiently trained with competent knowledge of the dumper and all controls?
- Is the operator fit and physically able to operate the dumper? An operator who is sick, tired or under the influence of alcohol or drugs is a dangerous operator.

WORKSITE

- Are there any steep gradients or precipices that need to be avoided?
- Is the ground solid and stable enough to operate the dumper?
- Are there any obstacles or hazards in the area that need to be taken into consideration? Eg. Power cables, barriers, man-hole covers, excavations?
- Are members of the public and unauthorised personnel cordoned off from the area the dumper is operating?
- Is the size of the worksite suitable for safely manoeuvring the dumper?

DUMPER

- Is the dumper in a suitable working condition?
- Have the pre-start checks listed in this manual been carried out, and any identified faults been rectified?

LOADS

- How heavy is the load - does it fall within the limits of the dumper?
- Is the load distributed evenly? An uneven load may cause the dumper to tip over.
- Is there a possibility of the load moving during operation?
- Does the load obscure the operator's vision?

WEATHER CONDITIONS

- Is it windy? Strong winds may affect the stability of the dumper, especially in the hi-tip position.
- Is it raining? Heavy rain may affect the operator's ability to safely drive the dumper. It may also make the ground soft, unstable and unsuitable for using the dumper.
- Is it foggy? Low fog may affect the visibility of the operator.
- Is lightning forecast? Lightning can kill! **DO NOT** use the dumper if there is lightning in the area.

SAFETY DECALS

Figure 6

- A - Forward / Neutral / Reverse Lever Decal
- B - Seatbelt Warning Decal
- C - Diesel Level Decal
- D - Skip Controls Decal
- E - Tyre Pressure / Wheel Nut Torque Decal
- F - Strapping Decal

- G - Articulation Area Warning Decal
- H - Lifting Point Decal
- J - Skip Crush Zone Decal
- K - Orange Beacon Decal
- L - Green Beacon Decal
- M - Tow Hitch Decal

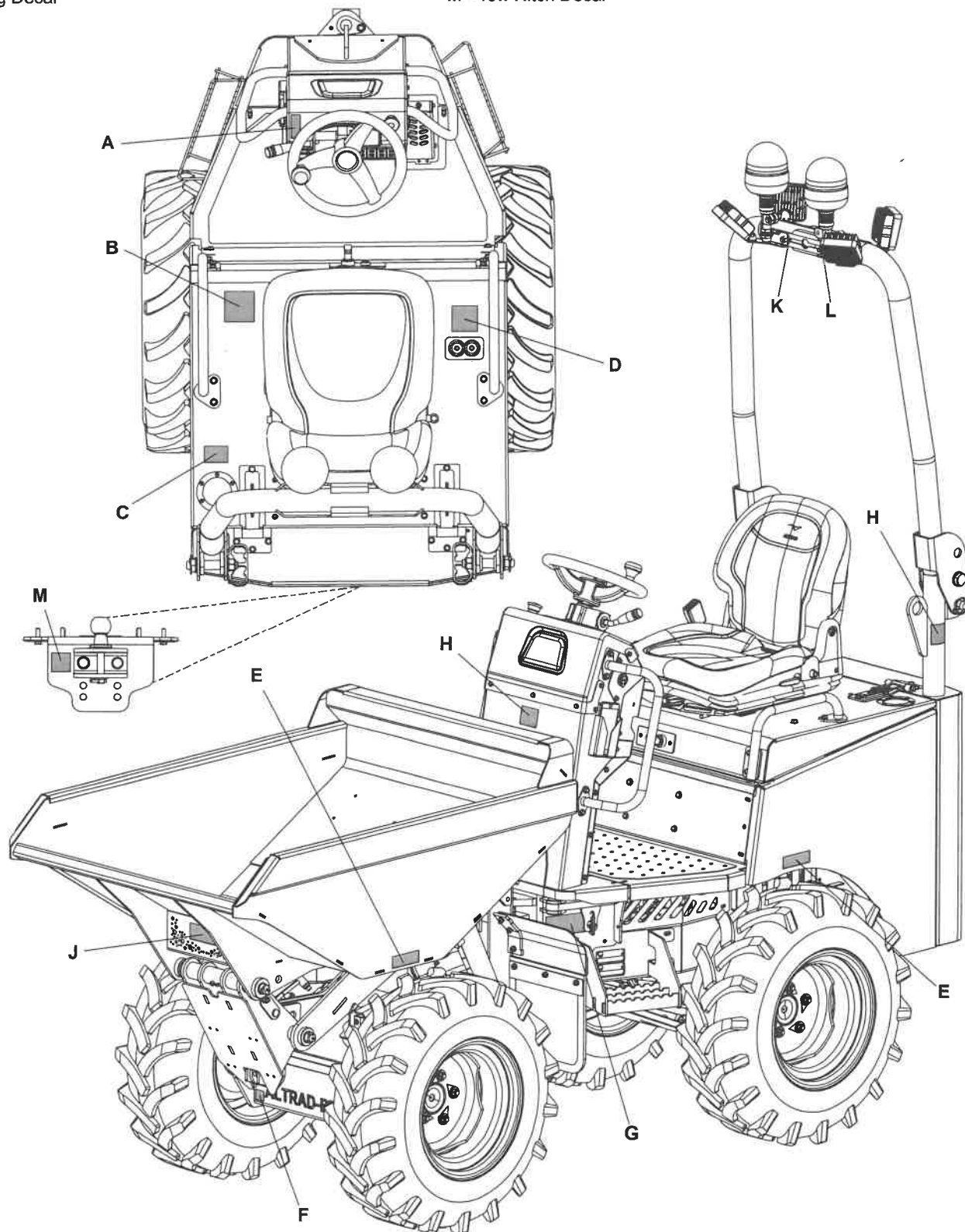

SAFETY DECALS

A - Forward / Neutral / Reverse Lever Decal

Instructions on how to drive the dumper. *F = Forward, R = Reverse, N = Neutral.*

B - Seatbelt Warning Decal

WARNING - always wear a seatbelt whilst driving or operating the dumper.

C - Diesel Level Decal

Highlights the position of the diesel level gauge.

D - Skip Controls Decal

Instructions on how to operate the dumper skip.

E - Tyre Pressure / Wheel Nut Torque Decal

Indicates the correct tyre pressure and wheel nut torque settings.

F - Strapping Decal

Highlights the correct positions to secure the dumper when transporting on a flatbed.

G - Articulation Lock Decal

Instructions on how to lock the articulation of the dumper.

H - Lifting Point Decal

Lifting point for use with a Sling or Mechanical Hoist.

J - Skip Crush Zone Decal

Beware of potential crush hazards projecting from the skip.

K - Orange Beacon Decal

Highlights the correct position of the Orange Beacon.

L - Green Beacon Decal

Highlights the correct position of the Green Beacon.

M - Tow Hitch Decal

If the dumper is used on site for towing trailers, the payload must be distributed with 25% in the dumper skip and 75% in the trailer. The maximum payload for the dumper must **NEVER** be exceeded with the combination of towed equipment and the weight in the dumper skip.

SAFETY DECALS**Figure 7**

- A - Fan Warning Decal
- B - Hydraulic Oil Level Decal
- C - Isolator Decal
- D - Radiator Warning Decal
- E - Diesel Fill Decal
- F - Engine Oil Decal
- G - Gradient Safety Decal
- H - General Safety Decal
- J - No Lifting Point Decal
- K - Cylinder Lock Warning Decal
- L - Tyre Pressure / Wheel Nut Torque Decal
- M - Hand Crush Warning Decal
- N - Lifting Point Decal
- P - Horn Decal
- Q - Emergency Stop Decal
- R - Ignition Decal
- S - Strapping Decal
- T - Articulation Area Warning Decal
- U - Chevron Decals

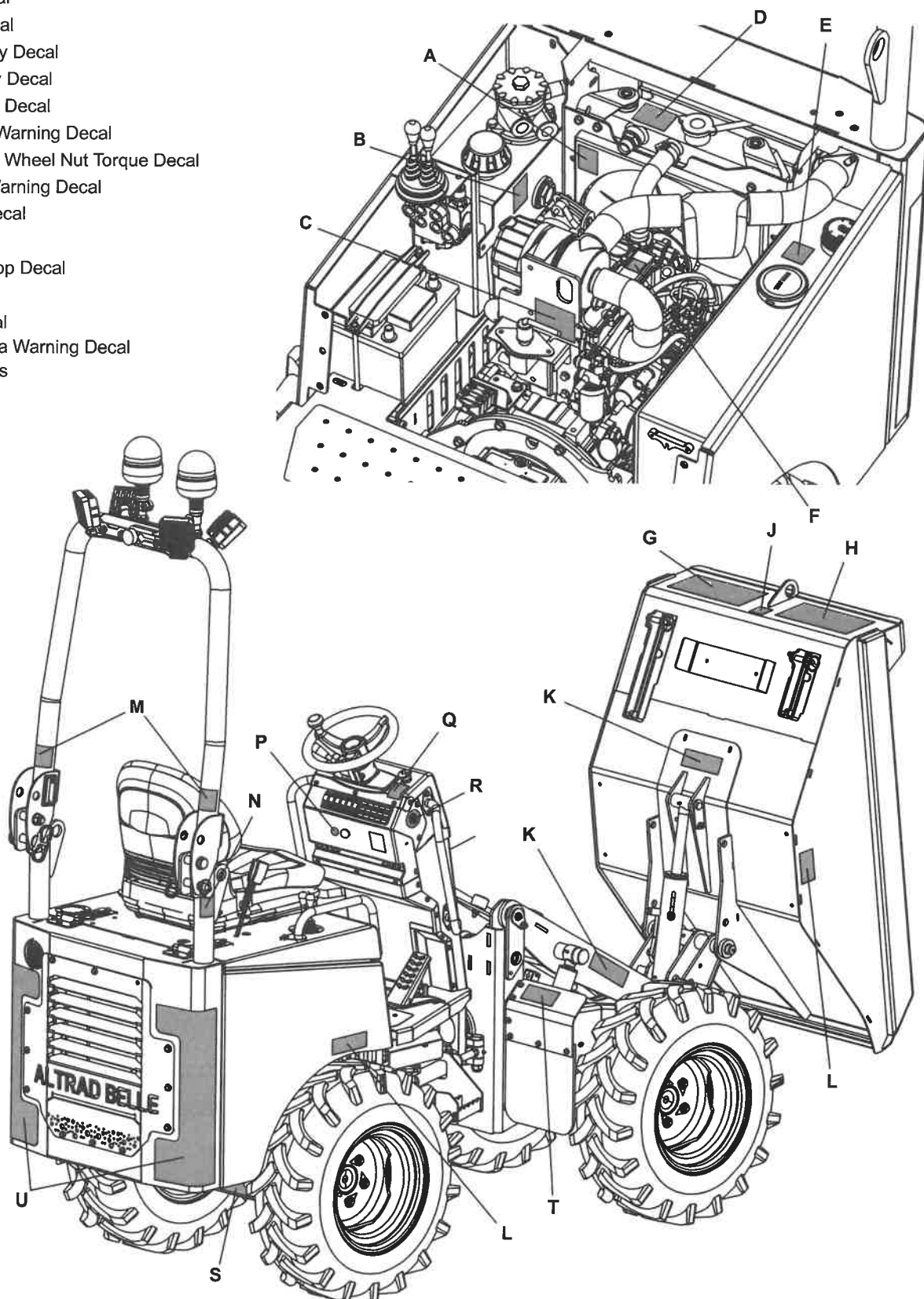

SAFETY DECALS

A - Fan Warning Decal

WARNING - fast moving fan that poses a risk of crushing.

B - Hydraulic Oil Level Decal

Indicates the position of the Hydraulic Oil Gauge which shows the level of Hydraulic Oil within the tank.

C - Isolator Decal

Instructions on how to isolate the battery (See page 33)

D - Radiator Warning Decal

The radiator may be **HOT**. Only unscrew the cap once cooled.

E - Diesel Fill Decal

Highlights the Diesel fill position. Engine must be filled with Diesel **ONLY!**

F - Engine Oil Decal

Explains the type of oil which should be used to fill the engine.

G - Gradient Safety Decal

Explains how to safely operate the machine on a gradient (See page 42).

H - General Safety Decal

WARNING - read the operators manual before operating the machine.

WARNING - high pressure hydraulic hoses that pose a risk of skin piercing.

WARNING - DO NOT carry passengers.

WARNING - NEVER carry loads with the skip raised or on a gradient.

J - No Lifting Point Decal

WARNING - DO NOT use this point to lift the dumper

K - Cylinder Lock Warning Decal

WARNING - The cylinders must be locked onto position using the designated securing struts when leaving the arms raised or skip tipped.

L - Tyre Pressure / Wheel Nut Torque Decals

Indicates the correct tyre pressure and wheel nut torque settings.

M - Hand Crush Warning Decals

WARNING - moving parts that pose a risk of crushing. Take care when moving the ROPS frame.

N - Lifting Point Decals

Lifting point for use with a Sling or Mechanical Hoist.

P - Horn Decal

Indicates the position of the horn.

Q - Emergency Stop Decal

Indicates the position of the emergency stop button.

R - Ignition Decal

Indicates the position of the ignition (See page 15)

S - Strapping Decals

Highlights the correct positions to secure the dumper when transporting on a flatbed.

T - Articulation Area Warning Decal

WARNING - articulation area that poses a risk of crushing. No unauthorised personnel in this area.

Highlights the correct positions to secure the dumper when transporting on a flatbed.

U - Chevron Decals

Increases on-site visibility of the dumper.